

Technical sheet

Ref. 010170

Steel scaffolding fixing guardrail for wooden structure

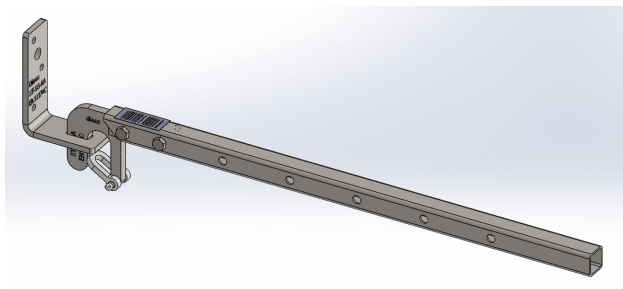

Fixing kits allow roof scaffolds and guardrails to be used for safe work.

FEATURES

Efficient, light and easy to assemble,
Not limiting in terms of space and assembly
Suitable for any type of roof (tile, slate, zinc, sloping or flat, new or renovation) or for the installation of solar panels
Meets the requirements of EN 13374 Class C

SPECIFICATIONS

Lenght (mm)	850
Width (mm)	50
Height (mm)	200
Weight (kg)	0

Technical description

Comprises
1 MOB anchorage (screws not included) ref 20170
1 anti-lift attachment pin ref. 20006

Actions : To work safely

Trades : Slate / Framework / Metal / Tile